

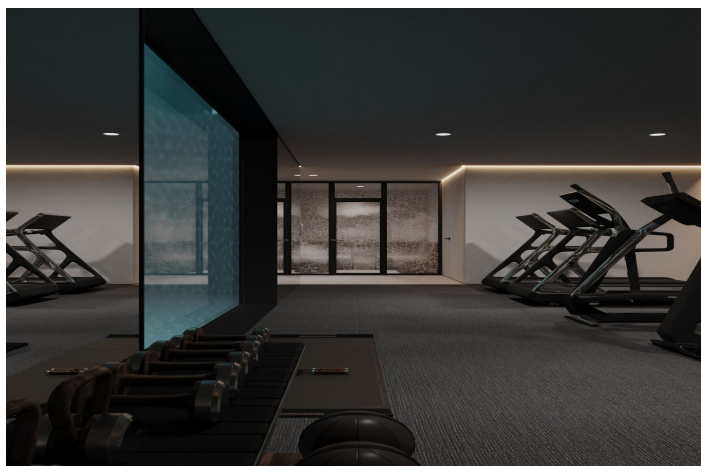

Detached Villa for sale in San Pedro de Alcántara, Marbella West

5,950,000 €

Reference: R5039233 Bedrooms: 8 Bathrooms: 9 Plot Size: 1,151m² Build Size: 877m²





Costa del Sol, San Pedro de Alcántara

This exceptional villa project in Cortijo Blanco, San Pedro, offers luxury and comfort across three beautifully designed levels. With 8 en-suite bedrooms, this property is contemporary and offers high-end finishes throughout. Each bedroom features built-in wardrobes, ensuring plenty of storage. The ground floor welcomes you with a bright open-plan layout where the living room flows into the dining area and modern kitchen. One en-suite bedroom is located on this level, offering convenience and privacy. The outdoor space is a true oasis, complete with a private swimming pool and landscaped garden—perfect for enjoying the Mediterranean climate in a tranquil setting. The first floor houses the luxurious master suite with a walk-in closet and private terrace. Two additional en-suite bedrooms are also located on this floor, each designed with elegance and functionality in mind. The basement is a highlight of the villa, designed for both leisure and practicality. It includes four en-suite bedrooms—ideal for guests or friends—alongside a game room and bar, perfect for entertaining or family game nights. A home cinema is perfect for movie nights, while a gym caters to fitness enthusiasts. For total relaxation, the spa area includes a massage room, sauna, and Turkish bath. A wine cellar, laundry room, and storage space complete this level. The villa is ideally located in close proximity to the beach and a short drive to golf courses, San Pedro town center, and Puerto Banús. Make this stunning villa yours!



Features:

Features

Storage Room
Double Glazing
Fitted Wardrobes
Gym
Sauna
Jacuzzi

Setting

Close To Sea
Close To Town

Garden

Private

Category

Luxury

Climate Control

U/F Heating

Condition

New Construction

Security

Alarm System

Views

Garden
Pool

Pool

Private

Parking

Private