

# Middle Floor Apartment for sale in Málaga, Málaga

980,000 €

Reference: R4732489 Bedrooms: 3 Bathrooms: 3 Build Size: 144m<sup>2</sup>

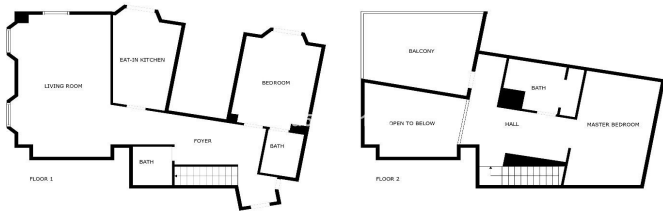

SIZES ARE APPROXIMATE, ACTUAL MAY VARY.



## Costa del Sol, Málaga

We invite you to discover this exclusive duplex penthouse located in a historic building in the heart of Malaga, near Carretera Street, recently pedestrianized and transformed into the new focal point of this vibrant city. This penthouse is part of a historic building completely renovated in 2020, with a spectacular design and high-quality finishes that have captivated both clients and investors since its construction and continue to arouse great interest. The duplex, located on the top floor and at the corner, features a charming terrace on the upper floor. Upon entering, you are greeted by a hall that leads to the 3 bedrooms on the ground floor, 2 bathrooms, the kitchen, and the elegant living room. The latter, with a double height and large wooden windows, offers beautiful natural light. The kitchen, separate, includes a small table perfect for breakfast. Upstairs, we find the master bedroom with a spacious bathroom and a reading corner. The terrace is the highlight of the duplex, with enough space to furnish with armchairs and a table to enjoy a drink at the end of the day, or loungers to sunbathe at any time of the year. The property is sold furnished and comes with an active tourist license that generates considerable annual income. Additionally, a large storage room in the basement of the building is included, as well as an elevator that provides direct access from the floor to the basement. Don't miss the opportunity to discover this exclusive duplex penthouse in the heart of Malaga. Come and visit it and discover a unique opportunity whether as your own home or a luxury investment.

## Features:

### Features

Lift  
Near Transport  
Private Terrace  
Storage Room  
Double Glazing  
Fitted Wardrobes  
Solarium  
Near Church  
Fiber Optic

### Setting

Close To Port  
Close To Shops  
Close To Town  
Close To Schools

### Climate Control

Central Heating

### Views

Mountain  
Panoramic  
Urban